



## DOCKLANDS, VIC

401/68 River Esplanade

2  
BED

2  
BATH

2  
CAR



### An inspired podium apartment with stunning river views

From the uninterrupted views of the stunning riverfront to the immense curved living zone which is truly unique when it comes to Docklands apartments, this 2 bedroom, 2 bathroom Yarra's Edge residence is low rise living at its very finest.

? In the boutique podium section of the esteemed Tower 3 complex with only 7 apartments in the low density block

? 1 dedicated lift servicing the 7 apartments in this block of the building

? Still owned by the original buyers and first time for sale since first purchase

? Generous and open plan central living and dining zone boasts full curved windows which frame the breathtaking river vistas

**\$900,000 - \$950,000**

**Contact:**

Baden Lucas  
03 9645 1199  
0418 888 751  
Baden Lucas  
03 9645 1199  
0418 888 751

**Type:** Apartment

**Sold Date:** 11/10/2019

**<https://www.resbymirvac.com>**

# 401/68 RIVER ESPLANADE, DOCKLANDS



This floorplan is an artist's impression only, it contains information that we believe to be reliable however we cannot guarantee and accept no responsibility for the accuracy of information supplied. All dimensions are indicative and listed in metres. Interested parties should take their own measurements or engage the services of a licensed surveyor.

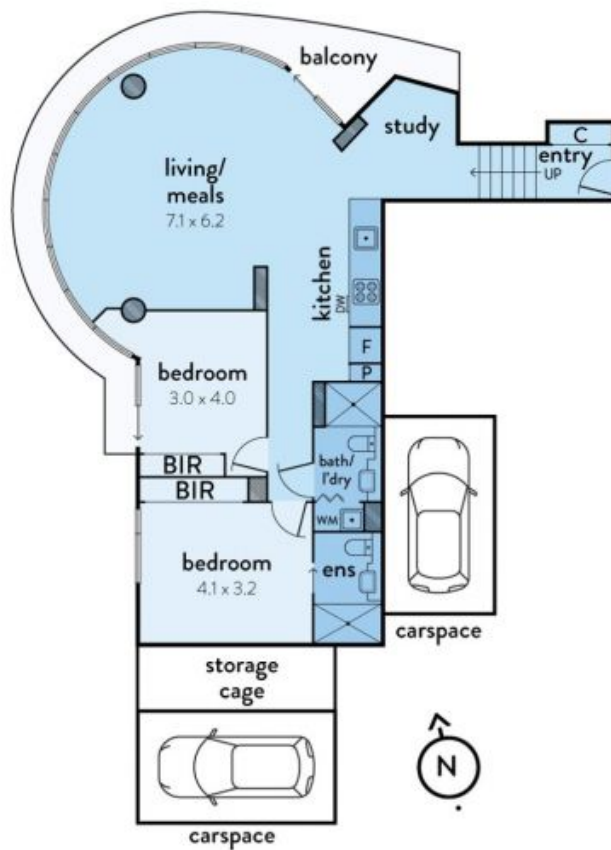

Plans shown are only indicative of layout. Dimensions are approximate.

**DOCKLANDS, VIC**  
401/68 River Esplanade