



DOCKLANDS, VIC

8 Foundry Way

4
BED

2
BATH

2
CAR



Price Improvement - Two floors of spacious and beautifully stylish town living

Boasting two exceptional levels of generous and ultra-modern living which will excite a variety of buyers who want to enjoy the best of the Yarra's Edge, this sublime 4 bedroom, 2.5 bathroom residence with a double remote garage is the ultimate Docklands house!

Featuring a superior build by Mirvac and with a unique floorplan (only 14 of these layouts exist with no more to be built), this dual level haven is filled with brilliant highlights. The downstairs lounge and dining zone is open and expansive, with this area feeding into the deluxe stone kitchen complete with soft-closing drawers and Miele/Asko stainless steel appliances. The kitchen further includes a large casual meals space.

Contact Agent

Contact: Baden Lucas
03 9645 1199
0418 888 751
Type: House
Sold Date: 09/02/2019
Land: 246Square Metres
<https://www.resbymirvac.com>

8 FOUNDRY WAY, DOCKLANDS



This floorplan is an artist's impression only, it contains information that we believe to be reliable however we cannot guarantee and accept no responsibility for the accuracy of information supplied. All dimensions are indicative and listed in metres. Interested parties should take their own measurements or engage the services of a licensed surveyor.

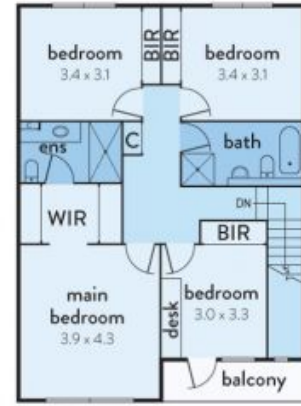

Plans shown are only indicative of layout. Dimensions are approximate.

DOCKLANDS, VIC
8 Foundry Way