



**DOCKLANDS, VIC**  
705/90 Lorimer Street

<b>2</b> BED	<b>1</b> BATH	<b>2</b> CAR	
-----------------	------------------	-----------------	--

**A Yarra's Edge marvel with space, style, and superb views**

Located in the fantastic 'Tower 5' in the Yarra's Edge precinct which sits just moments to all the action of South Wharf Promenade and DFO shopping, this tasteful and modern two bedroom apartment showcases a considered floorplan and two secure car spaces!

A sizeable undercover balcony has unique south-westerly views and will be your 2nd home during the warmer months as you enjoy drinks watching the sun setting in the distance. Inside, a sizeable lounge and dining zone is adjoined by a tiled stone kitchen complete with a moveable island bench and stainless steel Miele appliances.

Both bedrooms with mirrored built-in robes each boast fantastic privacy and are separated by the main living hub. Also benefit from a stylish double vanity bathroom, separate laundry, ducted heating and cooling, secure intercom, storage cage, 2 secure car spaces, and access to

RekDek with gym, pool, spa, steam room, and sauna.

Walk to South Wharf with restaurants and bars including Meat Market, The Boatbuilders Yard, The General Assembly, and Plus 5 Bar. You're also close to Crown Entertainment Complex, IGA supermarket, and public transport including Southern Cross Station and trams on Spencer Street.

**\$630,000 - \$660,000**

**Contact:** Baden Lucas  
03 9645 1199  
0418 888 751  
Baden Lucas  
03 9645 1199  
0418 888 751

**Type:** Apartment

**Sold Date:** 25/10/2018

**<https://www.resbymirvac.com>**

# 705/90 LORIMER STREET, DOCKLANDS



This floorplan is an artist's impression only, it contains information that we believe to be reliable however we cannot guarantee and accept no responsibility for the accuracy of information supplied. All dimensions are indicative and listed in metres. Interested parties should take their own measurements or engage the services of a licensed surveyor.

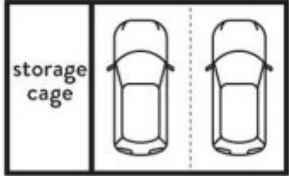
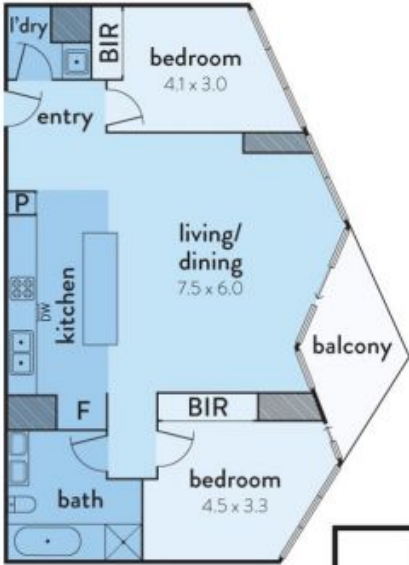

**carspaces**  
(not in position)

Plans shown are only indicative of layout. Dimensions are approximate.