

## ZETLAND, NSW

201/960 Bourke Street

**2** BED **2** BATH **2** CAR 

### 2-Bedroom Apartment with 2 x Carspaces in Zetland

This 92sqm, 2-Bedroom Apartment features:

- Large bedrooms with generous built-in wardrobes
- Open-plan living and dining area with North-facing balcony
- Contemporary kitchen with stone benchtops and Miele appliances
- Integrated refrigerator included
- Sleek bathrooms with plenty of vanity storage
- Internal laundry with dryer included
- Two secure car spaces side-to-side and storage cage included
- Ducted A/C, video intercom and NBN connectivity
- 300m to Woolworths, The Social Corner and Green Square Train Station (10mins to the City)

### DEPOSIT TAKEN

**Contact:** Carmen Whiteley  
02 8588 8888  
0497 555 519

**Type:** Apartment

**Date Available:** 14/05/2020

**Bond:** \$3100

<https://www.resbymirvac.com>

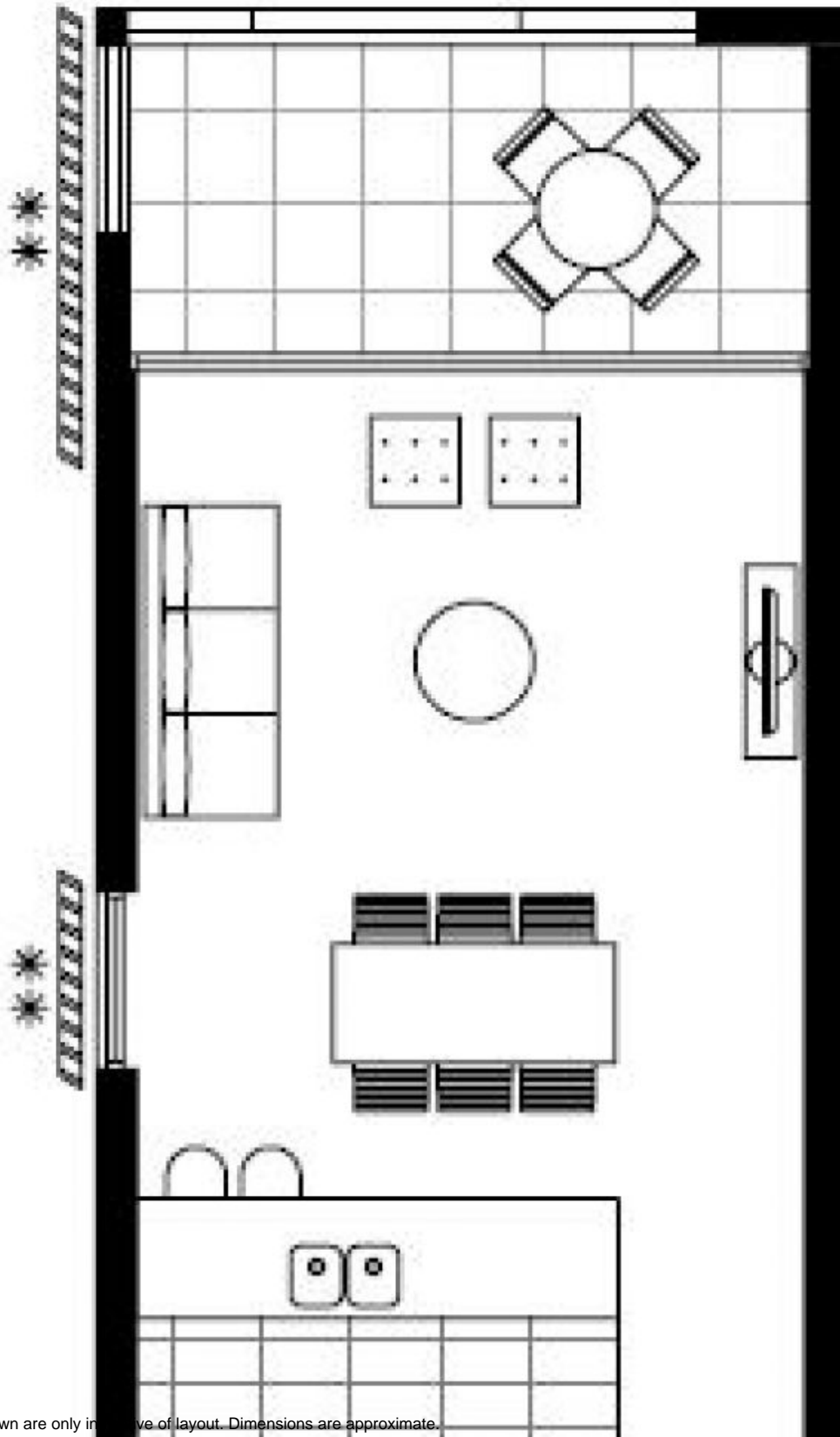

Plans shown are only indicative of layout. Dimensions are approximate.

**ZETLAND, NSW**  
201/960 Bourke Street