



**DOCKLANDS, VIC**  
908/50 Lorimer Street

**2** BED **2** BATH **2** CAR 

**Spacious two bedroom living at highly sought Yarra's Edge**

This stunning apartment located in the renowned tower 1 ? 50 Lorimer Street has it all with the comforts of a smart and central open plan living area with an abundance of light and space. The spacious gourmet kitchen is complemented with a large island stone bench top, and European stainless steel appliances and plenty of cupboard space, whilst two independently zoned bedroom quarters allow for a harmonious lifestyle thanks to dedicated main bathrooms and ensuite.

Extra features include floor to ceiling windows to the full-width private balcony, two tandem car spaces, ducted heating/cooling and use of the Rekdek facilities including fully equipped gymnasium, heated indoor lap pool, spa, sauna and rooftop decking.

**\$775 per week**

**Contact:** Baden Lucas  
03 9645 1199  
0418 888 751

**Type:** Apartment

**Date Available:** 03/09/2018

**Bond:** \$4650

**<https://www.resbymirvac.com>**

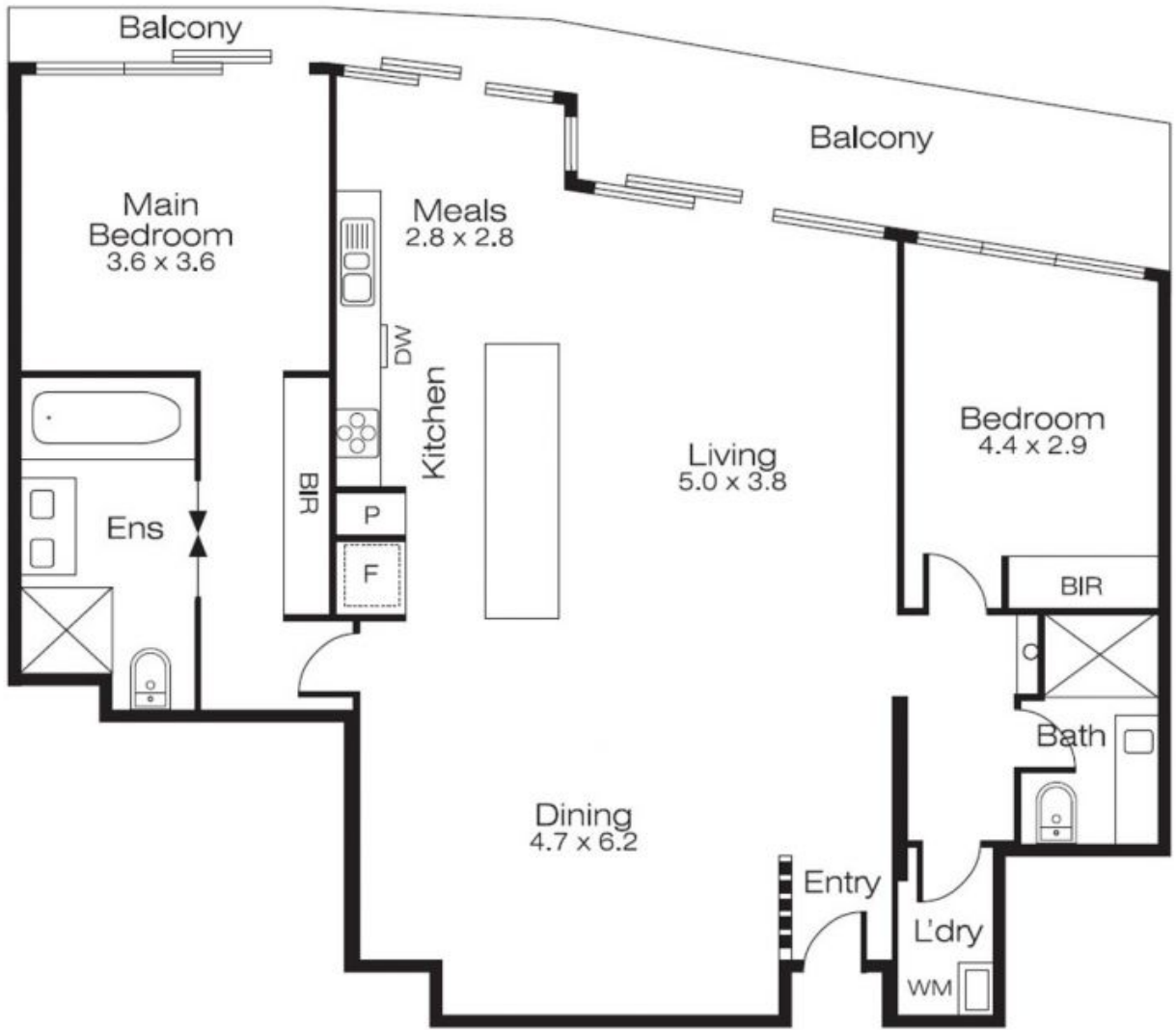

Plans shown are only indicative of layout. Dimensions are approximate.

**DOCKLANDS, VIC**  
908/50 Lorimer Street