



GLEBE, NSW

308/2 Scotsman Street

1
BATH



Over-sized Studio Apartment in Harold Park!

This 50sqm, level 3 Studio Apartment offers;

- Modern kitchen with stone benchtop and built-in appliances
- Bedroom space with built-in wardrobe and sliding partition doors
- Sleek bathroom with plenty of storage
- Large balcony with leafy outlook
- Internal laundry with washer and dryer included
- Secure storage cage included
- Ducted A/C, video intercom and NBN connectivity
- Walking distance to buses, the light rail and the Tramsheds

****Images indicative only****

510

Contact: Naz Sabzpouri
02 8588 8888
0401 545 440

Type: Studio

Date Available: 03/07/2018

Bond: \$2040

<https://www.resbymirvac.com>

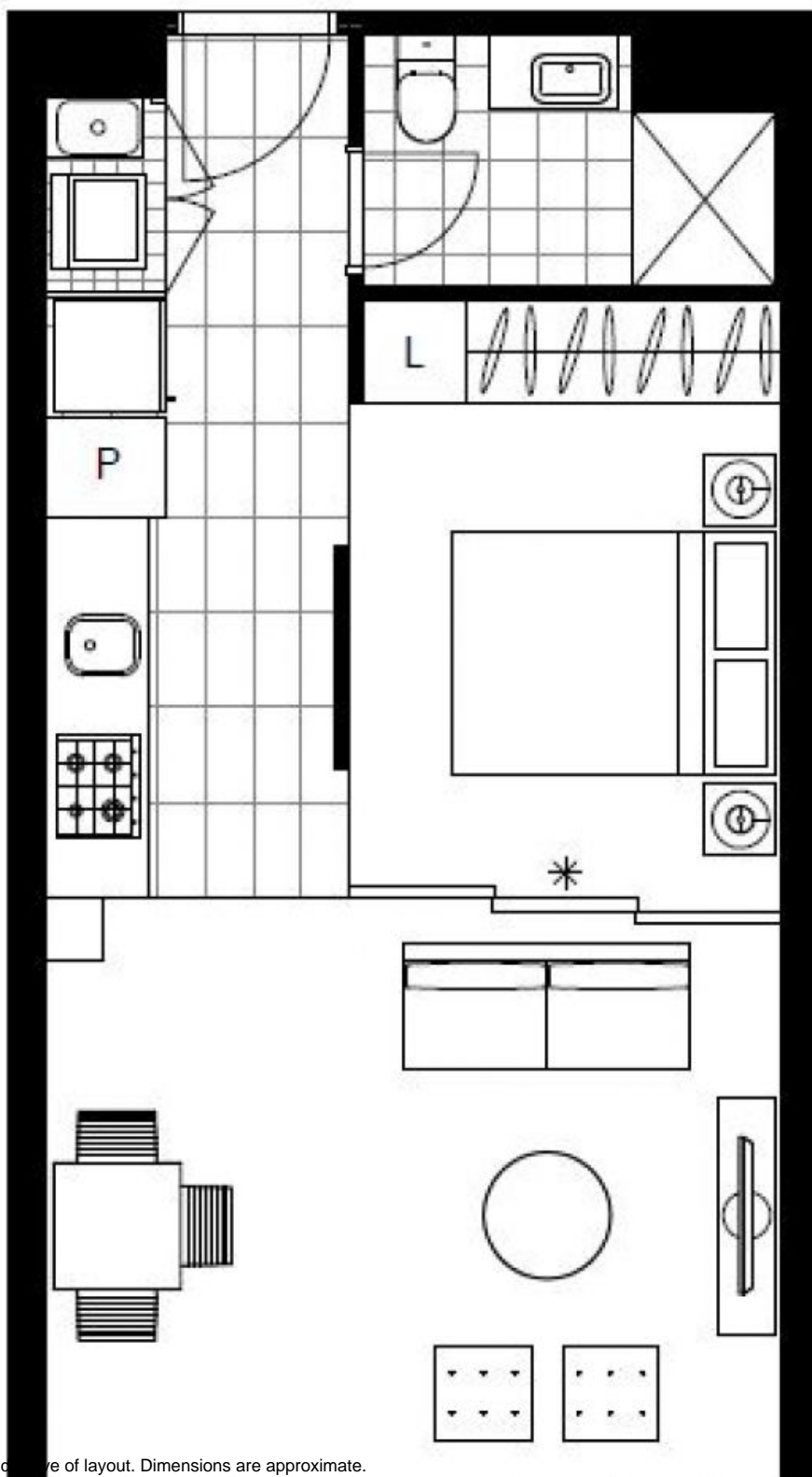

Plans shown are only indicative of layout. Dimensions are approximate.

GLEBE, NSW
308/2 Scotsman Street

