

DOCKLANDS, VIC

2305/90 Lorimer Street

2 BED **1** BATH **2** CAR 

Stunning apartment on the Yarras Edge

Located in Docklands premier Yarra's Edge precinct, this stunning apartment features a spacious central living area with adjoining balcony, huge host style kitchen with multiple configuration options with stone topped island bench, and stainless steel Miele appliances, Fisher & Paykel dish drawer and integrated refrigerator tick all the boxes when it comes to your living and dining needs. Each bedroom is smartly positioned either side of the living area, allowing space and comfort in each room along with built in wardrobes and that stunning view right throughout (master also includes access balcony). The oversize bathroom features double basin vanity, separate spa bath and separate shower recess.

Complete with full laundry, two secure car spaces, access to Mirvac's renowned Rek Dek gymnasium/pool, avail yourself of the opportunity to secure this exclusive address.

\$630 per week

Contact: Baden Lucas
03 9645 1199
0418 888 751

Type: Apartment

Date Available: 28/05/2018

Bond: \$3780

<https://www.resbymirvac.com>

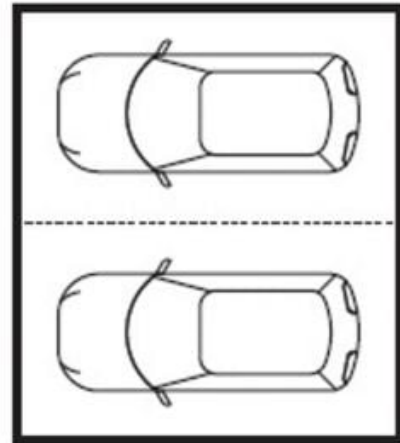
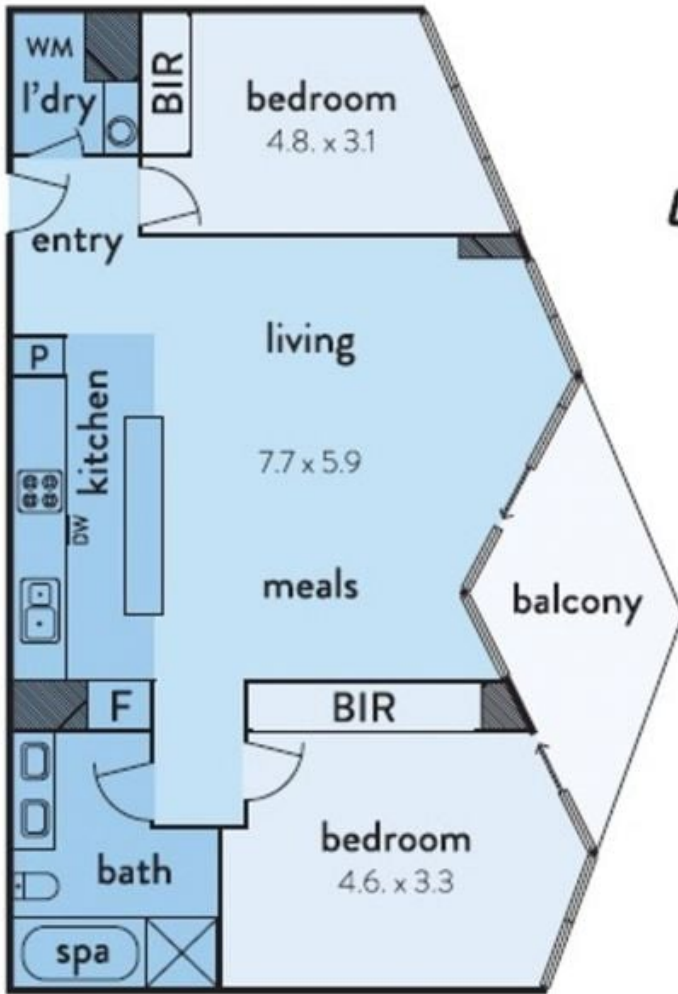

carspace
(not in position)

Plans shown are only indicative of layout. Dimensions are approximate.

DOCKLANDS, VIC
2305/90 Lorimer Street