



DONCASTER, VIC

6 Makybe Walk

4 BED **2** BATH **2** CAR 

Luxury Townhouse with park views

This exceptional example of the sustainable lifestyle Tullamore offers, this multi-level abode adorns premium fixtures and fittings with a thoughtful and practical floorplan sure to please both families and empty-nester's alike.

With a pleasant aspect overlooking one of Tullamore's master planned parks, you'll indulge in the generous full level open plan accommodation inclusive of living, dining and further family area.

** As a newly established estate, you won't find this property on google maps, please use www.whereis.com

or here are some directions to property:

Entering estate onto Heritage Boulevard. Turn right at the roundabout onto Members Drive. Turn right onto Stables Circuit. Turn left onto Phar Lap Drive and at end of the road the property is on the right adjoining the park.

\$750 per week

Contact: Baden Lucas
03 9645 1199
0418 888 751

Type: Townhouse

Date Available: 03/05/2018

Leased Date: 15/08/2018

Bond: \$4500

<https://www.resbymirvac.com>

ISSUE FOR COSTING

320D-DR4A-V
 Albert B_F2
 GA#:06.07



1 GA - Ground Floor plan AlbErt B_F2
 Scale: 1:150



2 GA - First Floor Plan Albert B_F2
 Scale: 1:150

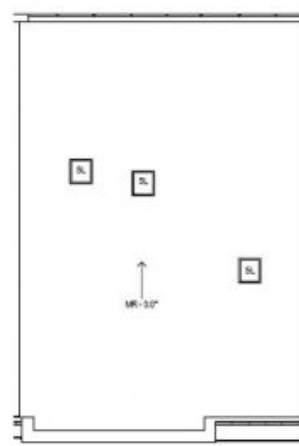

4 GA - Roof Plan Albert B_F2
 Scale: 1:150

| Total Living Area Schedule Albert Type B2 | |
|---|----------------------|
| Ground Floor | 99.2 m ² |
| First Floor | 106.4 m ² |
| Grand total | 205.6 m ² |

| Total Area Schedule Albert Type B2 | |
|------------------------------------|----------------------|
| Ground Floor | 99.2 m ² |
| First Floor | 106.4 m ² |
| Porch | 3.6 m ² |
| Carport | 53.2 m ² |
| Grand total | 262.4 m ² |

| Window Schedule B_F2 | | |
|----------------------|--------------|--------------|
| No. | Type | Comments |
| 1 | SD/SS/ASST | |
| 2 | SA/W/AC1 | |
| 3 | SA/W/AC1 | Face Windows |
| 4 | AT/PC/1207 | |
| 5 | AT/PC/1210 | |
| 6 | SA/W_F2/1207 | |
| 7 | SA/W_F2/1210 | |
| 8 | SA/W_F2/1211 | |

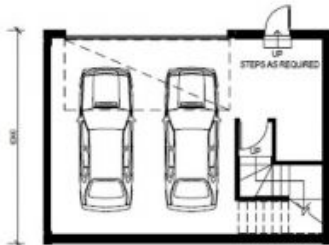

3 GA - Garage Floor Plan Albert B_F2
 Scale: 1:150



5 Key Plan CP09, M140
 Scale: 1:500

| Date | Rev | Description |
|----------|-----|--|
| 27.02.15 | A | ISSUE FOR COSTING |
| 24.11.15 | B | ISSUE FOR COSTING WINDOW SCHEDULE ADDS |

Project: EASTERN GOLF COURSE
 Stage 1

Author: [Name]
 Designer: [Name]
 Checker: [Name]
 Date: 27.02.15

Author: [Name]
 Approver: [Name]
GENERAL ARRANGEMENT XX
 Job Number: 1.0.01.0000
 Floor Type: B
 Date: 2015/02/27
 Drawing No: 014
 Title: 320D-DR4A-V

Plans shown are only indicative of layout. Dimensions are approximate.

DONCASTER, VIC
 6 Makybe Walk