



DONCASTER, VIC

6 Makybe Walk

4
BED

2
BATH

2
CAR



Luxury Townhouse with park views

This exceptional example of the sustainable lifestyle Tullamore offers, this multi-level abode adorns premium fixtures and fittings with a thoughtful and practical floorplan sure to please both families and empty-nester's alike.

With a pleasant aspect overlooking one of Tullamore's master planned parks, you'll indulge in the generous full level open plan accommodation inclusive of living, dining and further family area.

****** As a newly established estate, you won't find this property on google maps, please use www.whereis.com

or here are some directions to property:

Entering estate onto Heritage Boulevard. Turn right at the roundabout onto Members Drive. Turn right onto Stables Circuit. Turn left onto Phar Lap Drive and at end of the road the property is on the right adjoining the park.

\$750 per week

Contact: Baden Lucas
03 9645 1199
0418 888 751

Type: Townhouse

Date Available: 03/05/2018

Leased Date: 15/08/2018

Bond: \$4500

<https://www.resbymirvac.com>

ISSUE FOR COSTING

320D-DR4A-V
Albert B_F2
GA#:06.07

| Total Living Area Schedule Albert Type B2 | |
|--|----------------------|
| Ground Floor | 99.2 m ² |
| First Floor | 105.4 m ² |
| Grand total | 204.6 m ² |

| Total Area Schedule Albert Type B2 | |
|---------------------------------------|----------------------|
| Ground Floor | 99.2 m ² |
| First Floor | 105.4 m ² |
| Porch | 3.4 m ² |
| Carport | 53.2 m ² |
| Grand total | 261.4 m ² |

| Window Schedule B_F2 | | |
|----------------------|-------------|---------------|
| No. | Type | Comments |
| 1 | SD/SP/AS7 | |
| 2 | SA/WP/1421 | |
| 3 | SA/WP/1421 | Fixed Windows |
| 4 | AT/PC/1237 | |
| 5 | AT/PC/1237 | |
| 6 | SA/WP_F1247 | |
| 7 | SA/WP/1221 | |
| 8 | SA/WP/1221 | |



1 GA - Ground Floor plan AlbErt B_F2
Scale 1:100



2 GA - First Floor Plan Albert B_F2
Scale 1:100

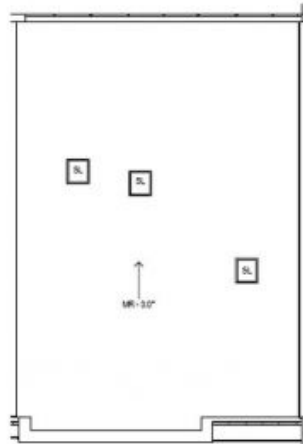

4 GA - Roof Plan Albert B_F2
Scale 1:100

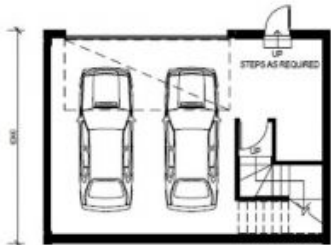

3 GA - Garage Floor Plan Albert B_F2
Scale 1:100



5 Key Plan CP09, M140
Scale 1:500

| Date | Rev | Description |
|----------|-----|--|
| 27.02.15 | A | ISSUE FOR COSTING |
| 24.11.15 | B | REVISION FOR COSTING WINDOW SCHEDULE ADDED |

project
EASTERN GOLF COURSE
Stage 1

Copyright © 2015. All rights reserved. This document is the property of Mirvac Design Pty Ltd. No part of this document may be reproduced without the written permission of Mirvac Design Pty Ltd.

checked
Mirvac Design
architect
planner
structural engineer

Level 10, 200 (Angkor) St
Sydney, NSW 2000
Tel: 02 8550 8000
Fax: 02 8550 8001
Mirvac Design Pty Ltd
ABN 79 002 585 101

mirvac

drawn: Author
approved: Approver
the GENERAL
ARRANGEMENT
XX
Job Number: 3.001.00000
File Name: 320D-DR4A-V @ A3-A0
drawing no: 014
index: 000

Plans shown are only indicative of layout. Dimensions are approximate.

DONCASTER, VIC
6 Makybe Walk