



## GLEBE, NSW

508/2 Scotsman Street

1  
BATH



### Deposit Taken!

This 50sqm, 5th floor Studio Apartment features:  
Stylish Studio Apartment in Harold Park

- Bed area with sliding dividers, separating living and sleeping
- Generous floor to ceiling built-in wardrobe
- Open-plan living and dining area flowing onto balcony
- Modern kitchen with stone benchtops and Miele appliances
- Sleek bathrooms with plenty of vanity storage
- Large balcony with leafy outlook
- Internal laundry with washing machine and dryer included
- Ducted Air conditioning, video intercom and NBN connectivity
- 400m to the Tramsheds, light rail station and public transport

### Deposit Taken

**Contact:** Matthew Matthews  
02 8588 8888  
0418 266 590  
Stuart Nohra  
02 8588 8888  
0432 206 000

**Type:** Studio

**Date Available:** 12/03/2019

**Bond:** \$2080

<https://www.resbymirvac.com>

For more information, please contact Real Estate Services by Mirvac on 02 8588 8888 or email [enquiries@resbymirvac.com](mailto:enquiries@resbymirvac.com) - Your Onsite Agent!

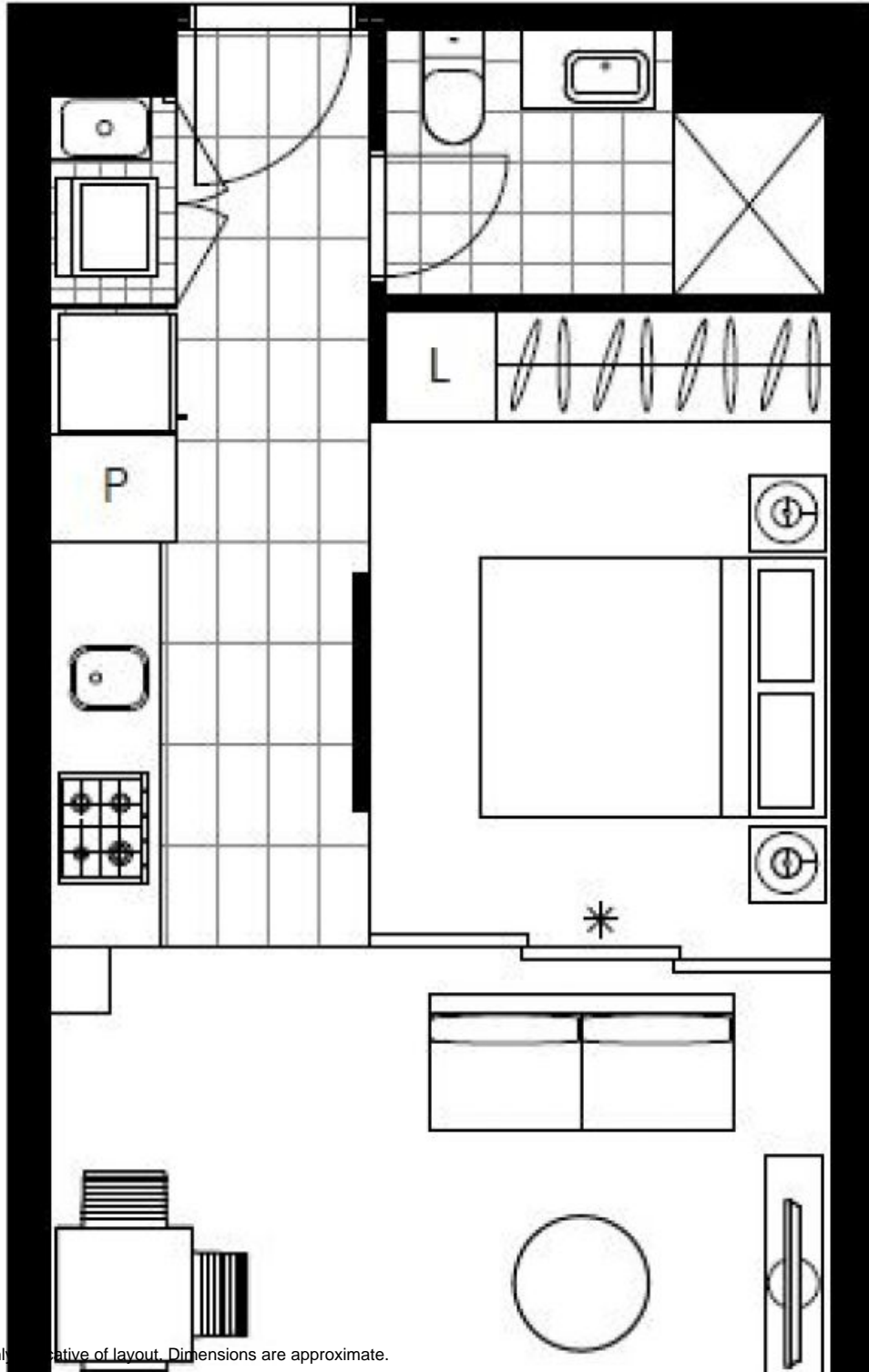

Plans shown are only representative of layout. Dimensions are approximate.

**GLEBE, NSW**  
508/2 Scotsman Street

