



## DOCKLANDS, VIC

2803/90 Lorimer Street

2  
BED

2  
BATH

2  
CAR



### Flawless Tower 5 Excellence with Elevated Harbour and City Views

Graced with outstanding custom upgrades and impeccable views of the scenic Yarra's Edge marina and the iconic city skyline, this unprecedented two bedroom, two bathroom apartment sits on the 28th floor of 'Tower 5' and promises magnificent Yarra's Edge living.

Quality craftsmanship and superb attention to detail will get your attention immediately. A generous and open plan lounge and dining zone has a fantastic north-east orientation, with this central zone effortlessly flowing out to the huge undercover balcony which takes in views of the resplendent river and city plus Port Phillip Bay.

The kitchen boasts upgraded marble countertops including a sizeable island bench, Ilve and Qasair stainless steel appliances, and integrated Liebherr fridge and freezer. The master retreat is an amazing space all on its own, with a large walk-in robe, beautiful spa ensuite, and its own

access to the generous balcony.

Further take advantage of a 2nd bedroom with a built-in robe, central marble bathroom with a European laundry, ducted heating and cooling, motorised blinds, C-bus lighting system, Bose surround-sound system, full height pivot doors to bedrooms, secure intercom, 2 secure car spaces, and access to RekDek which includes a gym, pool, spa, steam room, and sauna.

#### **Contact Agent**

**Contact:** Baden Lucas  
03 9645 1199  
0418 888 751  
Baden Lucas  
03 9645 1199  
0418 888 751

**Type:** Apartment

**Sold Date:** 10/07/2018

**<https://www.resbymirvac.com>**

# 2803/90 LORIMER STREET, DOCKLANDS

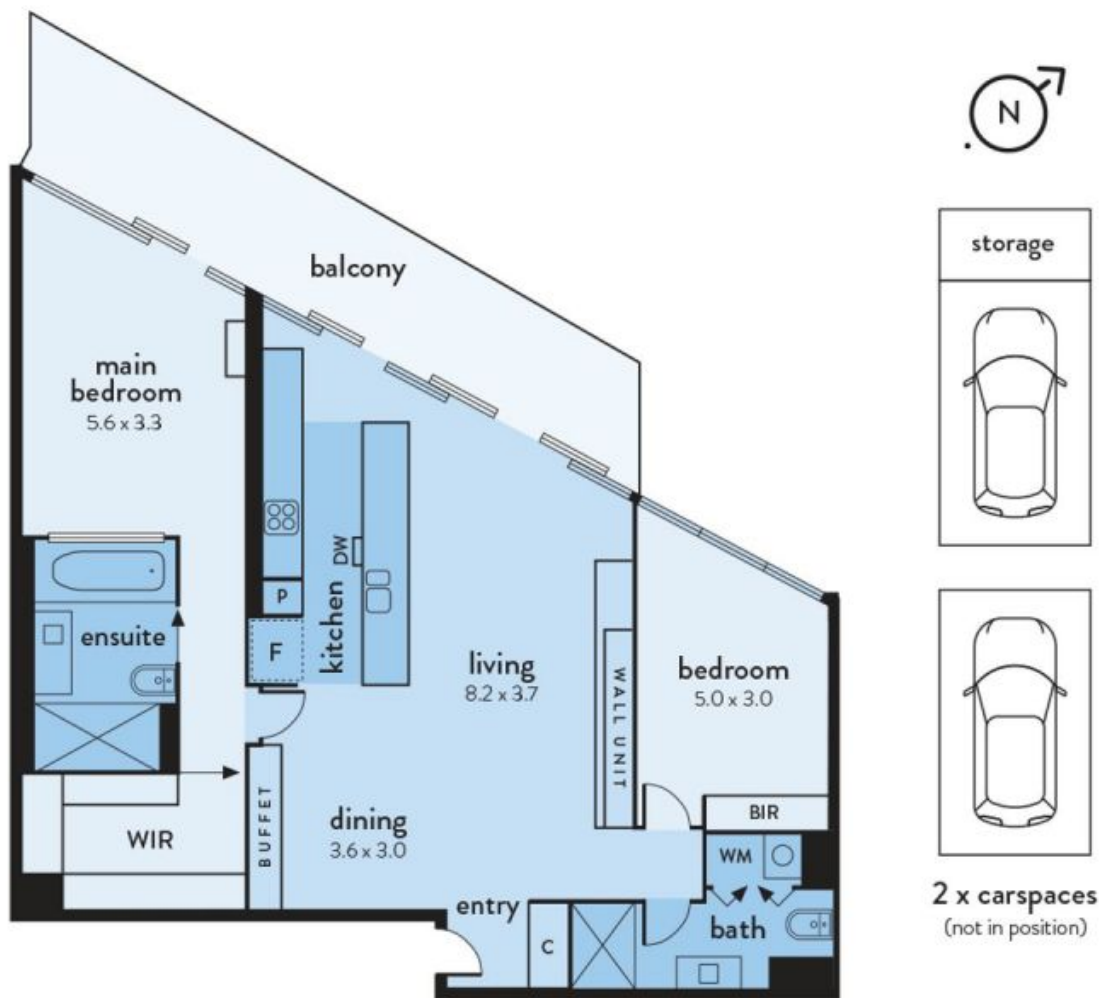

real estate  
services  
by mirvac

Plans shown are only indicative of layout. Dimensions are approximate.

The above plan is an artist's impression only, it includes elements that are for display purposes and may not be to scale. Dimensions are approximate and every care has been taken to verify the accuracy of details.

**DOCKLANDS, VIC**  
2803/90 Lorimer Street