



## DOCKLANDS, VIC

807/1 Point Park Crescent

2  
BED

1  
BATH

1  
CAR



### Yarra Point brilliance with a waterside location

For buyers who love fantastic space and outstanding quality in the amazing Yarra's Edge precinct, this wonderfully modern two bedroom residence is the perfect Docklands apartment right on the edge of the iconic Yarra River.

The well-sized open plan living and dining zone is a genuine highlight of this 8th floor residence, with this airy space a dream for everyday relaxing thanks to bright full windows and premium carpet. Sliding doors open out from this central hub which allows residents to access the balcony, which provides a quiet alfresco zone to enjoy after work drinks and your Sunday morning coffee.

The straight line kitchen is made from quality stone and comes with stainless steel Miele appliances. Both bedrooms with BIRs get superb afternoon sun and are excellent rooms to view picturesque sunsets, while further embrace a gorgeous bathroom with floor-to-ceiling tiles, European

laundry, ducted heating and cooling, secure intercom, secure car space, and access to RekDek with gym, pool, spa, steam room, and sauna.

In the Yarra's Edge precinct, you're not far from South Wharf Promenade with restaurants and bars including Meat Market, Common Man, Gasolina, and West Village NYC, DFO shopping, Crown Casino, Spencer Street trams, and Southern Cross Station.

**\$550,000 - \$600,000**

**Contact:** Baden Lucas  
03 9645 1199  
0418 888 751

**Type:** Apartment

**Sold Date:** 14/04/2018

**<https://www.resbymirvac.com>**

# 807/1 POINT PARK CRESCENT, DOCKLANDS

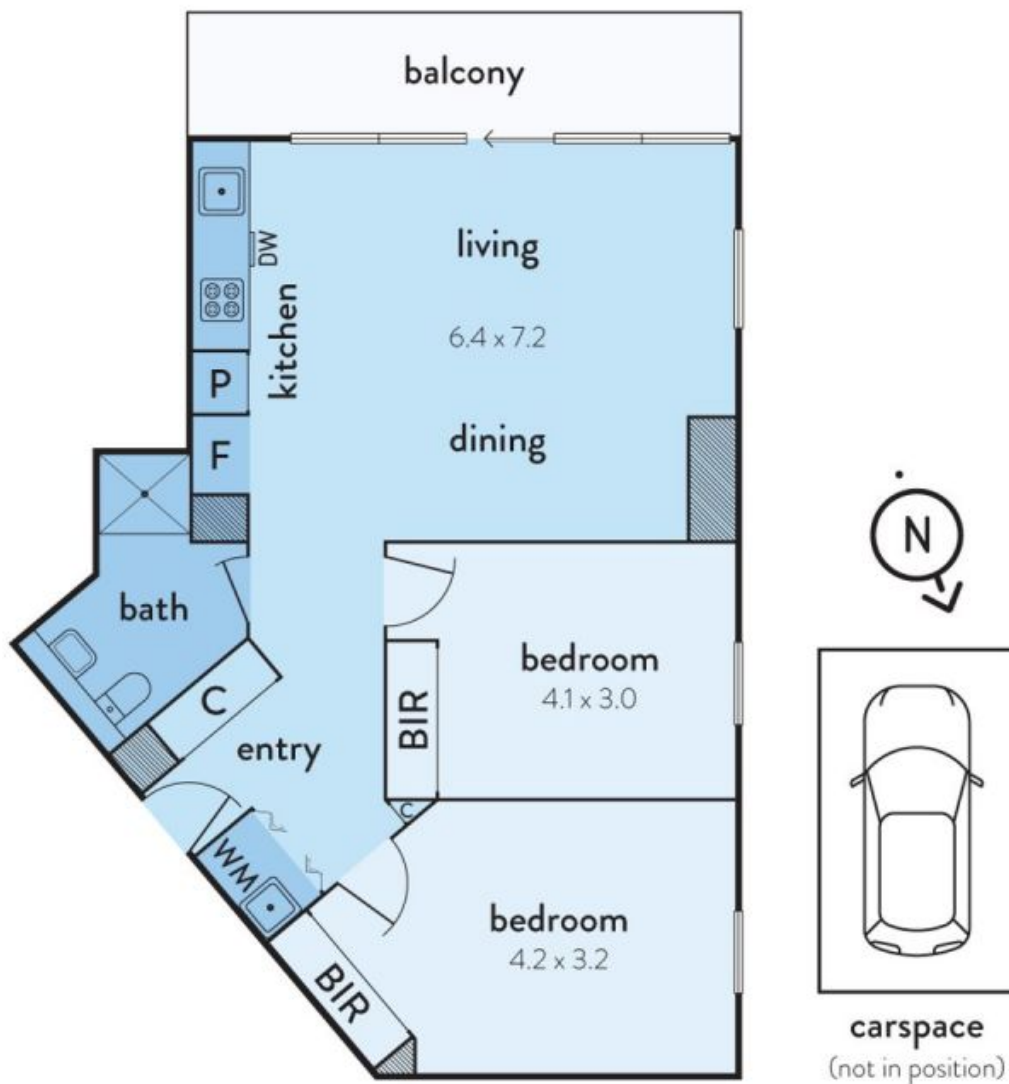

real estate  
services  
by mirvac

Plans shown are only indicative of layout. Dimensions are approximate.

The above plan is an artist's impression only, it includes elements that are for display purposes and may not be to scale. Dimensions are approximate and every care has been taken to verify the accuracy of details.

**DOCKLANDS, VIC**  
807/1 Point Park Crescent