



## DOCKLANDS, VIC

1005/81 South Wharf Drive

2  
BED

2  
BATH

1  
CAR



### North-Facing Forge Oasis is a Stylish Standout

With an enviable northerly aspect that allows for truly special views of the memorable city skyline, this brand new two bedroom, two bathroom apartment in the Forge complex is one of the best opportunities in the Yarra's Edge precinct.

With contemporary grace and a considered floorplan which makes the most of the space and views, this 10th floor apartment will have widespread appeal. Sizeable and open lounge and dining includes a dazzling stone kitchen featuring elegant cabinetry and Smeg stainless steel appliances.

There are three access points out to the balcony (from central living and both bedrooms), with this wonderful alfresco zone brilliant to soak in the CBD and Yarra River views as well as out to the rest of the Docklands. Both bedrooms are equipped with built-in robes including the master haven which also delivers an ensuite. Enjoy a sumptuous central

bathroom, concealed laundry, heating and cooling, video intercom and a secure car space. Residents also has access to the exclusive Wharf Club with gym, pool and caf? as well as a private kitchen/dining room and cinema.

Walk to South Wharf promenade with restaurants and bars including Citizen Caf? and Bar, Melbourne Public, Bangpop, and Munich Brauhaus. You're also near the Victoria Harbour precinct, Crown Entertainment Complex with world class restaurants, Port Melbourne and South Melbourne attractions, and Southern Cross Station.

#### **Contact Agent**

**Contact:** Baden Lucas  
03 9645 1199  
0418 888 751

**Type:** Apartment

**Sold Date:** 24/04/2018

**<https://www.resbymirvac.com>**

# 1005/81 SOUTH WHARF DRIVE, DOCKLANDS

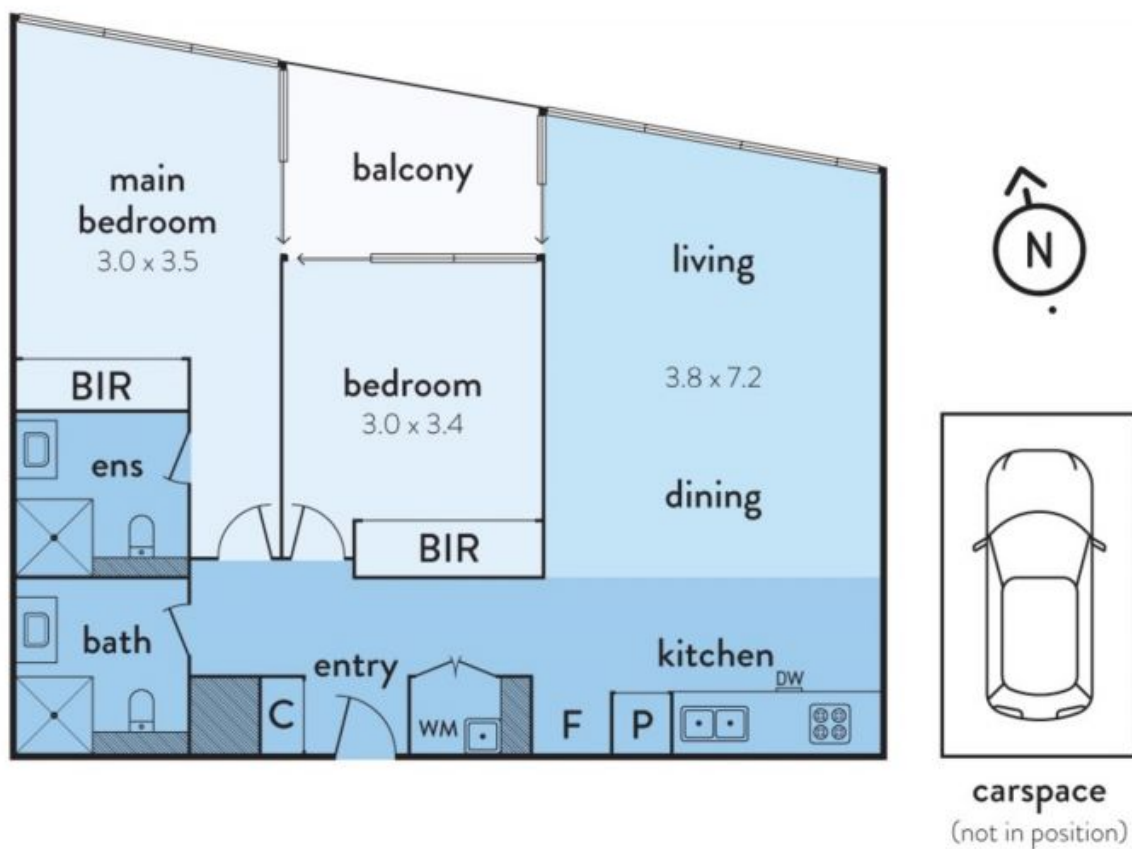

real estate  
services  
by mirvac

Plans shown are only indicative of layout. Dimensions are approximate.

The above plan is an artist's impression only, it includes elements that are for display purposes and may not be to scale. Dimensions are approximate and every care has been taken to verify the accuracy of details.

**DOCKLANDS, VIC**  
1005/81 South Wharf Drive