



## DOCKLANDS, VIC

411/81 South Wharf Drive

1  
BED

1  
BATH

1  
CAR



### An Inspirational New Offering with Amazing CBD Views

Grab a slice of the utterly luxurious, relaxed, and comfortable Docklands life with this brand new dual level one bedroom apartment with a northern orientation, which has an enviable location in Yarra's Edge newest residential jewel, 'Forge Apartments'.

An incredibly unique floorplan is split into two distinct levels allowing for dedicated and private areas to live and sleep. The generous living zone has an abundance of space for both lounge and dining while also integrating the stylish stone kitchen which is pleasing on the eye with elegant cabinetry and stainless steel appliances.

The balcony via a sliding floor-to-ceiling glass door feeds off the living zone and displays exceptional views of the city in the distance as well as the Yarra River, meanwhile on its own secluded level is the sizeable bedroom offering a built-in robe and the immaculate bathroom. Other extras are a European laundry, ducted heating and cooling, video

intercom entry, and secure car space.

The benefit of living in the Forge complex is that you get to enjoy being part of the new Wharf's Entrance area of the precinct, which offers a quiet and village-like lifestyle as well as a facilities including Wharf's Club with gym and pool, and a private kitchen/dining room and cinema for you to use at your own leisure.

**\$660,000 - \$690,000**

**Contact:** Baden Lucas  
03 9645 1199  
0418 888 751  
Baden Lucas  
03 9645 1199  
0418 888 751

**Type:** Apartment

**Sold Date:** 20/06/2017

**<https://www.resbymirvac.com>**

# 411/81 SOUTH WHARF DRIVE, DOCKLANDS

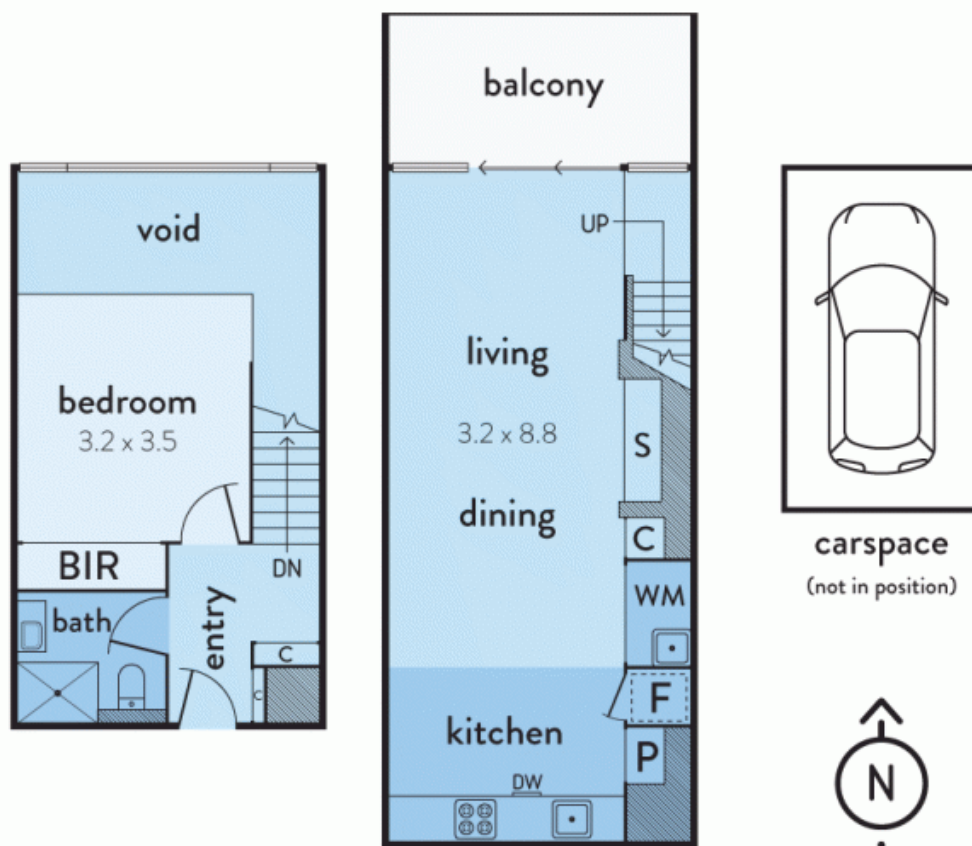

real estate  
services  
by mirvac

Plans shown are only indicative of layout. Dimensions are approximate.

The above plan is an artist's impression only, it includes elements that are for display purposes and may not be to scale. Dimensions are approximate and every care has been taken to verify the accuracy of details.

**DOCKLANDS, VIC**  
411/81 South Wharf Drive