



GLEBE, NSW

408/2 Scotsman Street

1
BATH



Stylish and Modern, Open-Plan Apartment in Glebe

This 50sqm, Level 4 Apartment offers;

- Modern kitchen with stone benchtop and built-in appliances
- Bedroom space with floor to ceiling built-in wardrobe and sliding partition doors
- Sleek bathroom with plenty of storage
- Large balcony with leafy outlook
- Internal laundry with washing machine and dryer included
- Ducted A/C, video intercom and NBN connectivity
- Walking distance to buses, the light rail and the Tramsheds

\$440 per week

Contact: Naz Sabzpouri
02 8588 8888
0401 545 440

Type: Studio

Date Available: 26/09/2020

Bond: \$1760

<https://www.resbymirvac.com>

For more information, please contact Real Estate Services by Mirvac on 02 8588 8888 or email enquiries@resbymirvac.com - Your onsite agent!

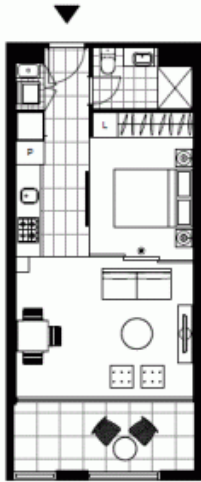

LEVEL 2.4

Plans shown are only indicative of layout. Dimensions are approximate.

GLEBE, NSW
408/2 Scotsman Street